

Plug in. Power up. Move on.

New 2-way socket outlet base with Wago connector

On busy construction sites, every second counts. The new Stago® 2-way base socket outlet with WAGO WINSTA® connector delivers speed, simplicity, and reliability when you need it most.

No cutting, stripping, or clamping needed. Just plug in, power up, and move on. It's the very essence of effortless and efficient installation, saving you precious time.

No need to worry about reliability either. With the new Stago 2-way base socket outlet with WAGO WINSTA® connector, quality comes prewired.

Quick guide

Perfect quick coupling with Wibe Group
and WAGO WINSTA® solutions

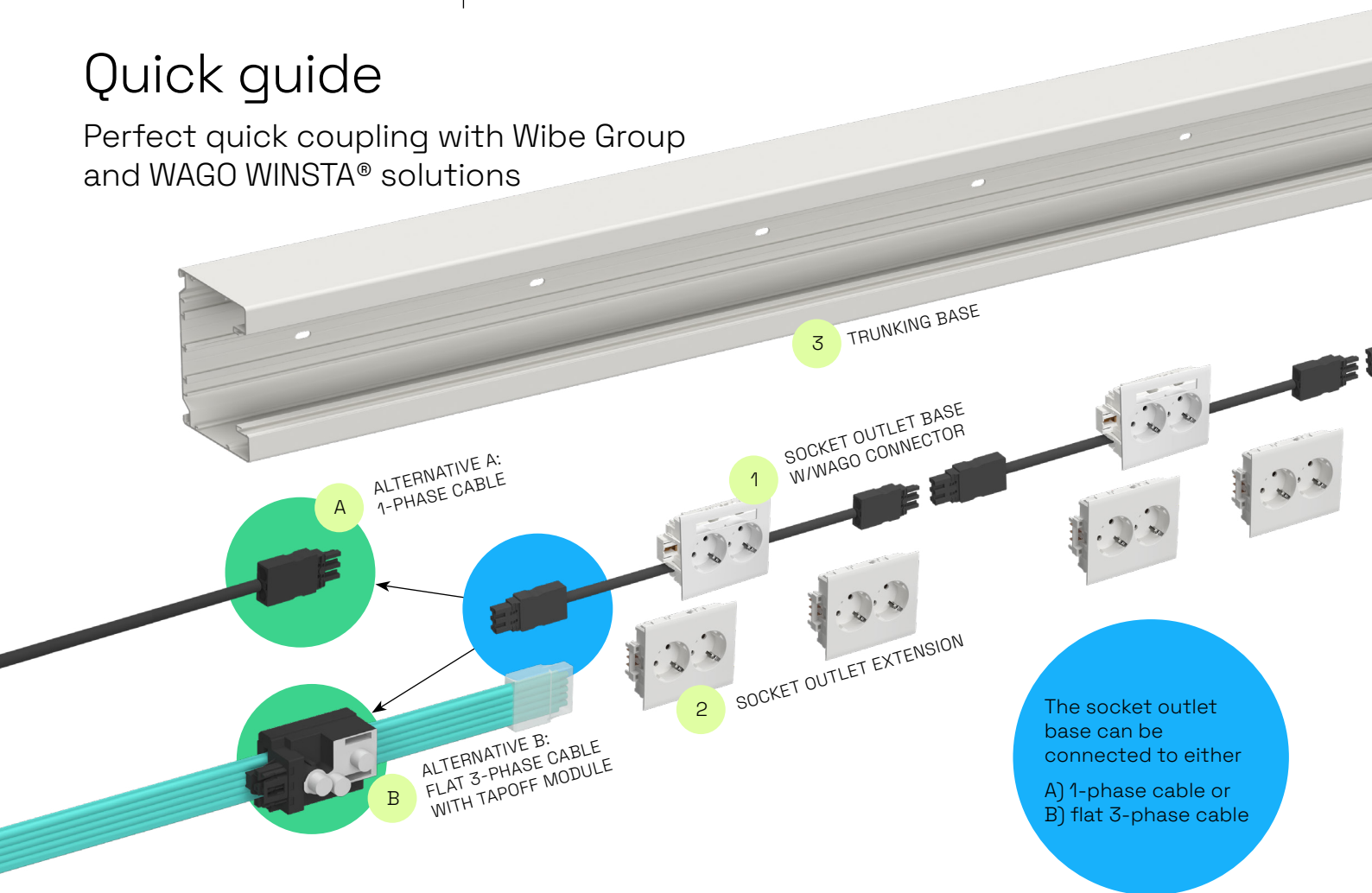

Stago products

- | | |
|---|-----------------------------------|
| <p>1 STA501081 2-way socket outlet base with Wago connector</p> <p>Front cover:</p> | <p>2 Socket outlet extension:</p> |
| | <p>3 Trunking base:</p> |

Wago products

- | | |
|---|--|
| <p>A Cca 3-pole; Cod. A; H05Z1Z1-F 3G 2,5 mm² black</p> <p>771-9393/167-501 Female/Open end 5m black</p> <p>771-9393/067-201 Cable Male/female 2m black</p> <p>771-9393/067-301 Cable Male/female 3m black</p> <p>771-9393/067-501 Cable Male/female 5m black</p> <p>770-101 Locking clip black</p> | <p>B Flat 3-phase cable</p> <p>897-252 Flat cable 5G 2,5mm² B2ca green</p> <p>772-261 Supply module 5-pole 4mm²</p> <p>772-263 Tap-Off Module, 3-Pole</p> <p>897-250 Endcap flatcable 5x2,5/5x4mm²</p> |
|---|--|

Locking clip required in order
to comply with IEC 61535