

SCEPTER[®] molded 5° coupling

The Scepter[®] 2" to 5" 5° molded couplings are produced from high quality, Schedule 40 PVC and feature a longer socket length which allows for easier installation in the field. These molded couplings are CSA approved and suitable for direct burial applications as well as exposed outdoor usage.

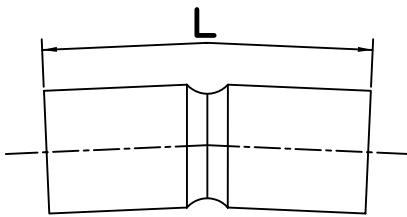

Size inches	Part Number	Product Code	Length inches
2	5EC35	077100	4.0
2-1/2	5EC40	077101	5.5
3	5EC45	077103	6.0
3-1/2	5EC50	077102	7.0
4	5EC55	277092	7.0
5	5EC60	277093	7.5
6*	5EC65	077106	11.0

*Fabricated

Features and Benefits:

- B x B ends with longer socket length
- CSA approved
- Durable PVC construction for long life



Contact us

Visit our website: ipexna.com

Toll free Canada: (866) 473-9462

Products manufactured by IPEX Electrical Inc.