

Product data sheet

Specifications

SQUARE D



Meter mains, QO, CSED, ringed socket, 125A, surface mount, no bypass

CQRB100CP

Product availability: Stock - Normally stocked in distribution facility

Main

Product or Component Type	Meter Mains
Range of Product	QO
Includes	Circuit-breaker 1) 2P 100 A 120/240 V AC main supply ready assembled

Complementary

Line Rated Current	125 A
Short-circuit current	10 kA
Network number of phases	1
Meter socket type	Ringed
Mounting	Surface (outdoor)
Number of spaces	0
Number of circuits	0
Number of Tandem Breakers	0
Hub type	B
Electrical connection	Lugs, line side Lugs, service ground
Wire Size	AWG 4...AWG 1/0 aluminium/copper)line side AWG 8...AWG 1/0 aluminium/copper)service ground
Disconnect	Service disconnect (factory installed)
Main Breaker Rating	100 A
Service feed location	OH UG
Bypass type	No bypass
Height	12.80 in (325.12 mm)
Width	13.82 in (351.03 mm)
Depth	4.39 in (111.51 mm)
Bus Rating	100.0 A

Environment

Product certifications	UL E-6294
------------------------	-----------

Ordering and shipping details

Category	US1DE3A00022
----------	--------------

Price is "List Price" and may be subject to a trade discount – check with your local distributor or retailer for actual price.

Discount Schedule	DE3A
GTIN	047569044021
Returnability	Yes
Country of origin	MX

Packing Units

Unit Type of Package 1	PCE
Nbr. of units in pkg.	1
Package 1 Height	5.60 in (14.224 cm)
Package 1 Width	14.20 in (36.068 cm)
Package 1 Length	15.00 in (38.100 cm)
Package weight(Lbs)	15.439 lb(US) (7.003 kg)
Unit Type of Package 2	PAL
Number of Units in Package 2	57
Package 2 Height	40.00 in (101.600 cm)
Package 2 Width	40.00 in (101.600 cm)
Package 2 Length	48.00 in (121.920 cm)
Package 2 Weight	912.0002 lb(US) (413.676 kg)

Environmental Data

Schneider Electric aims to achieve Net Zero status by 2050 through supply chain partnerships, lower impact materials, and circularity via our ongoing “Use Better, Use Longer, Use Again” campaign to extend product lifetimes and recyclability.

[Environmental Data explained >](#)

[How we assess product sustainability >](#)

Environmental footprint

[Environmental Disclosure](#)

[Product Environmental Profile](#)

Use Better

Materials and Substances

Packaging made with recycled cardboard

No

Packaging without single use plastic

Yes

[EU RoHS Directive](#)

Compliant with Exemptions

REACH Regulation

[REACH Declaration](#)

California proposition 65

WARNING: This product can expose you to chemicals including: Lead and lead compounds, which is known to the State of California to cause cancer and birth defects or other reproductive harm. For more information go to www.P65Warnings.ca.gov

Use Again

Repack and remanufacture

Circularity Profile

No need of specific recycling operations

Take-back

No

Technical Illustration

Dimensions

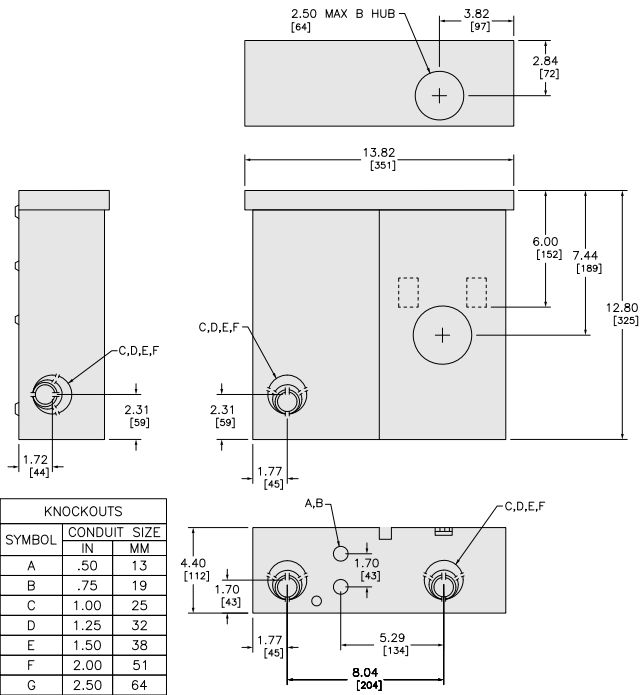

All dimensions are approximate. Also refer to technical documentation.

Technical Illustration

Wiring diagram

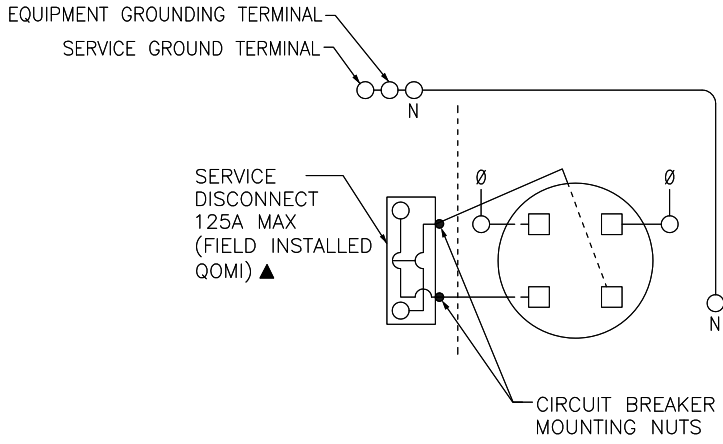

Image of product / Alternate images

Alternative



100 A

120/240 V-, 1Ø,
50/60 Hz., 3 wires/filos
208Y/120 V-, 1Ø,
50/60 Hz., 3 wires/filos

Main Breaker
Interruptor
Principal

Rainproof
Resistente a la
intemperie

Ring Type
Tipo anillo

**Underground
or Overhead**
Aérea o Subterránea

INCLUDES INCLUIDOS



Surface
Sobreponer
4-jaw meter socket
Base de medición con 4 mordazas
16 lbs / 7.12 kg
W13.4" x H12.7" x D4.3"