



AREA LIGHT SERIES

OUTDOOR FIXTURE



CONSTRUCTION

- Slim, Low-Profile Design
- Rugged IP66 Rated Die-cast Aluminum
- Optimal Heat Sink Dissipation
- Multiple Housing Finishes Available
- 10-year Warranty

ELECTRICAL

- Universal Voltage 120-277V Class 2 Power Supply Integral to Fixture (Dimming Optional)
- High Voltage 347-480V Available
- 4kV Surge Suppression Standard (10kV/20kV Optional)

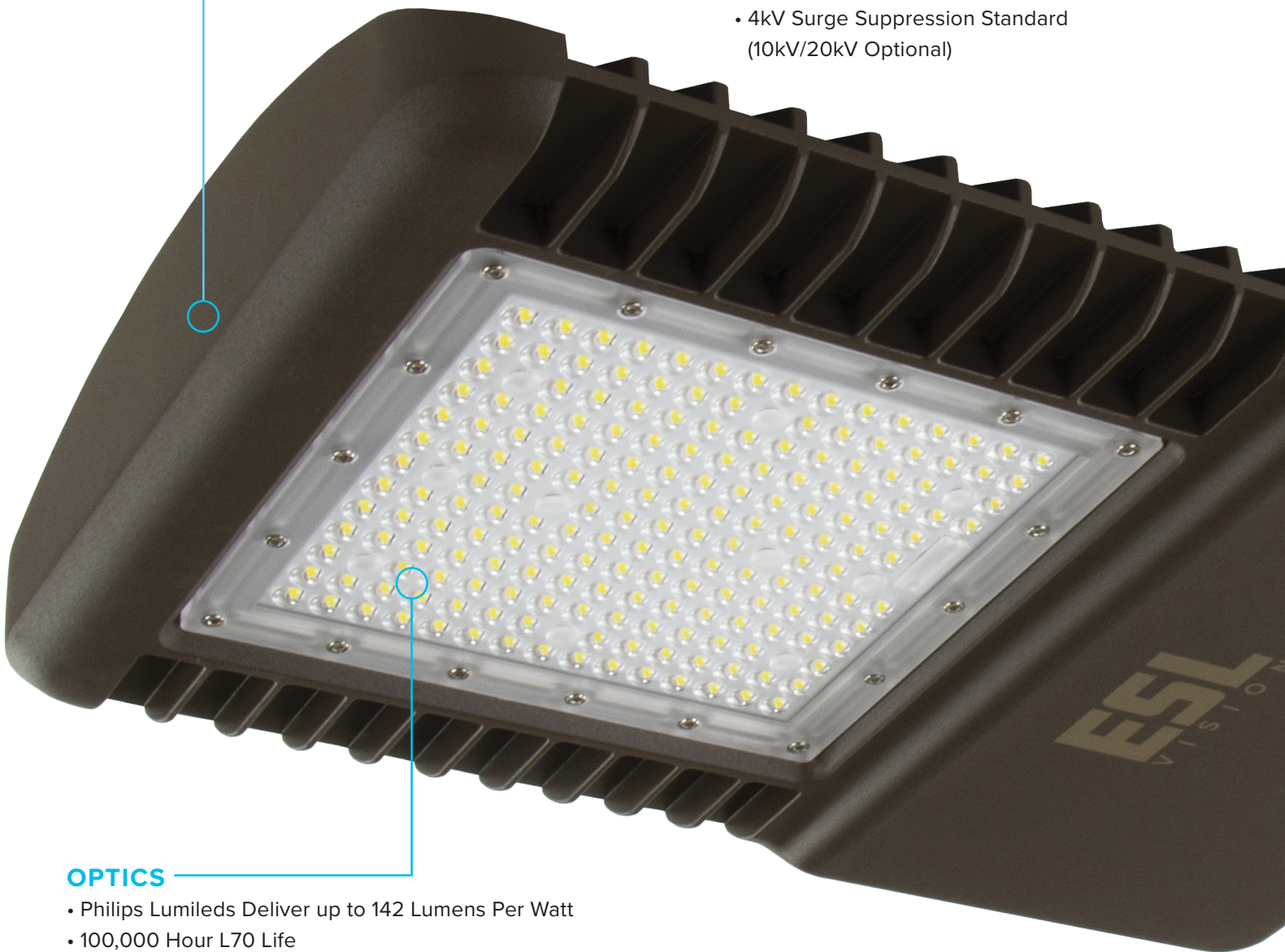

OPTICS

- Philips Lumileds Deliver up to 142 Lumens Per Watt
- 100,000 Hour L70 Life
- 22+ Years of Maintenance Free Operation
- Shatter and Impact Resistant Lens with UV Stabilization
- Type III, IV and V Distribution Patterns
- Available in 3000K, 4000K and 5000K



PHOTOCELL

- On/Off
- 0-10V Dimming
- 480V Photocell Available



OCCUPANCY SENSOR

- Field Programmable Using Handheld Remote
- Adjustable Dimming and Time Delay
- 0-10V Dimming
- IP66 Outdoor Rated



MOUNTING

- Slip Fitter
- Direct Arm
- Trunnion
- Yoke Mount
- Pole Mount
- * Round Direct Mount (4" and 5")

OPTIONS

DISTRIBUTION

The figures below showcase the three distribution types and suggested uses. ESL Vision's lighting design engineers can help create custom lighting layouts for your project **FREE OF CHARGE**.

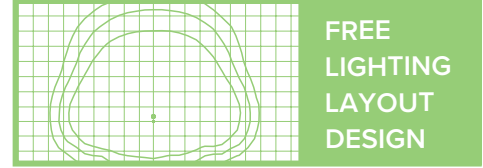

TYPE III



TYPE V

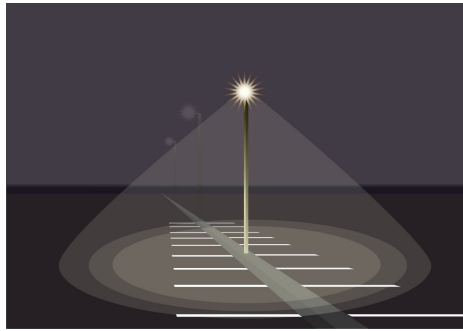

TYPE IV (STANDARD)

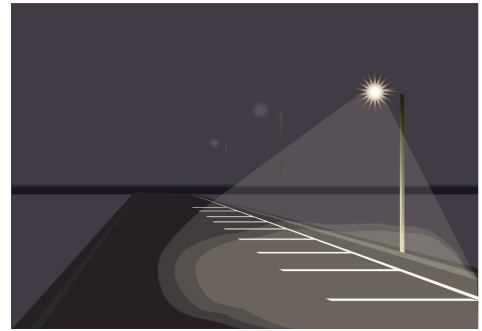

FINISHES



BRONZE (STANDARD)



BLACK



GREY



WHITE



CUSTOM

MOUNTS

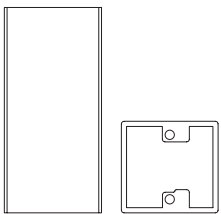

DIRECT ARM MOUNT

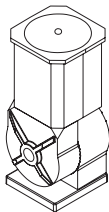

SLIP FITTER

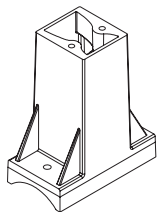

POLE MOUNT

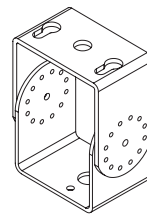

YOKE MOUNT

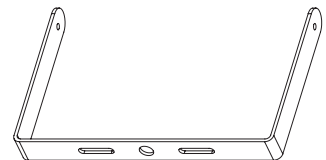

TRUNNION MOUNT

CONTROLS

ESL Vision Area Lights are available with optional integrated occupancy and photocell controls. The occupancy sensor can be factory programmed or set in the field using ESL's hand-held remote programming system.

The Occupancy Sensor allows for On/Off settings or controlled dimming to 10/20/30%. With 6 time settings (10 seconds to 60 minutes) and a 40-foot range, the Occupancy Sensor can be used for virtually any application.

ESL Vision offers several photocell and receptacle options:

- 3-pin for Simple On/Off Control
- 5-pin for 0-10V Dimming Options
- 7-pin for 0-10V Dimming and Future-Proofing Capabilities

CONTROL OPTIONS	RPC3 (3 wire)	RPC5 (5 wire)	RPC7 (7 wire)
Photo Control Only (On/Off)	✓ Yes	☾ Dimming Capable	☾ Dimming Capable
Occupancy Sensor	📱 On/Off	☾ Dimming Capable	☾ Dimming Capable



For Mounting Heights up to 40'

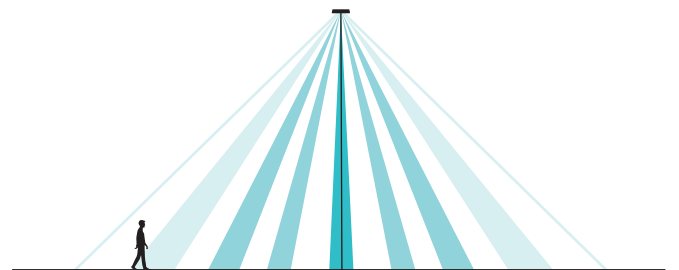
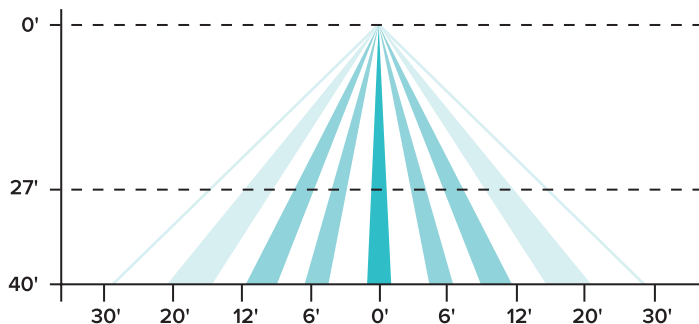

ORDERING GUIDE & SPECS

ESL	AL		1					
ESL	TYPE	WATTS	GENERATION	KELVIN	VOLTAGE	HOUSING	MOUNTING	LENS
	AL (Area Light)	75W 185W 110W 230W 150W 265W	1 (1st Generation)	30 (3000 Kelvin)* 40 (4000 Kelvin) 50 (5000 Kelvin)	Blank (120-277V) HV (347-528V)	BZ (Bronze) BK (Black)** WH (White)** GR (Grey)** OT (Other)**	SF (Slip Fitter) DM (Direct Arm Mount) TM (Trunnion Mount) YM (Yoke Mount) RDM-4 (Round 4" Pole Mount) RDM-5 (Round 5" Pole Mount) RDM-6 (Round 6" Pole Mount)	Type IV (Standard) Type V Type III

*3000K is DLC listed and available upon request

**Not typically stocked

OPTIONS (Add as Suffix)

- 5OCC (Occupancy Sensor)
- PCOF3 (3-Pin Receptacle On/Off Photocell)
- PCOF5 (5-Pin Receptacle On/Off Photocell)
- PCOF7 (7-Pin Receptacle On/Off Photocell)
- PCSC3 (3-Pin Receptacle with Shorting Cap)
- PCSC5 (5-Pin Receptacle with Shorting Cap)
- PCSC7 (7-Pin Receptacle with Shorting Cap)

OPTIONS (Order Separately)

- ESL-RPC3 (3-Pin Twist Lock Receptacle)
- ESL-RPC5 (5-Pin Twist Lock Receptacle)
- ESL-RPC7 (7-Pin Twist Lock Receptacle)
- ESL-PCOF (On/Off Photocell)
- ESL-PCSC (Shorting Cap)
- ESL-AL1SShield-xx (House Side Shield for 75W to 150W) Field Installed**
- ESL-AL1LShield-xx (House Side Shield for 185W to 265W) Field Installed**
- ESL-8OCC-ODD-LV
- ESL-REM100

* For other mounting options please see our post mount accessories

** Please specify housing finish

HOUSE SIDE SHIELD:

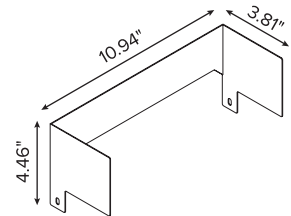

75 | 110 | 150 WATT

	PRODUCTS	MAX lm/W	MAX LUMENS	AVAILABLE KELVIN (xx)	AVAILABLE VOLTAGE	HOUSING FINISH (yy)	MOUNT (zz)
75 WATT	ESL-AL-75W-1xx-yy-zz	142	10,675	3000K (30) 4000K (40) 5000K (50) 5700K (57)	120-277 VAC 347-528 VAC (HV)	BRONZE (BZ) BLACK (BK) WHITE (WH) GREY (GR) OTHER (OT)	SLIP FITTER (SF) DIRECT ARM (DM) TRUNNION (TM) YOKE (YM) RDM-4 RDM-5
110 WATT	ESL-AL-110W-1xx-yy-zz	129	12,900	3000K (30) 4000K (40) 5000K (50) 5700K (57)	120-277 VAC 347-528 VAC (HV)	BRONZE (BZ) BLACK (BK) WHITE (WH) GREY (GR) OTHER (OT)	SLIP FITTER (SF) DIRECT ARM (DM) TRUNNION (TM) YOKE (YM) RDM-4 RDM-5
150 WATT	ESL-AL-150W-1xx-yy-zz	118	17,765	3000K (30) 4000K (40) 5000K (50) 5700K (57)	120-277 VAC 347-528 VAC (HV)	BRONZE (BZ) BLACK (BK) WHITE (WH) GREY (GR) OTHER (OT)	SLIP FITTER (SF) DIRECT ARM (DM) TRUNNION (TM) YOKE (YM) RDM-4 RDM-5

ORDERING GUIDE & SPECS

185 | 230 | 265 WATT

	PRODUCTS	MAX lm/W	MAX LUMENS	AVAILABLE KELVIN (xx)	AVAILABLE VOLTAGE	HOUSING FINISH (yy)	MOUNT (zz)
185 WATT	ESL-AL-185W-1xx-yy-zz	138	25,450	3000K (30) 4000K (40) 5000K (50) 5700K (57)	120-277 VAC 347-528 VAC (HV)	BRONZE (BZ) BLACK (BK) WHITE (WH) GREY (GR) OTHER (OT)	SLIP FITTER (SF) DIRECT ARM (DM) TRUNNION (TM) YOKE (YM) RDM-4 RDM-5
230 WATT	ESL-AL-230W-1xx-yy-zz	128	29,370	3000K (30) 4000K (40) 5000K (50) 5700K (57)	120-277 VAC 347-528 VAC (HV)	BRONZE (BZ) BLACK (BK) WHITE (WH) GREY (GR) OTHER (OT)	SLIP FITTER (SF) DIRECT ARM (DM) TRUNNION (TM) YOKE (YM) RDM-4 RDM-5
265 WATT	ESL-AL-265W-1xx-yy-zz	127	33,595	3000K (30) 4000K (40) 5000K (50) 5700K (57)	120-277 VAC 347-528 VAC (HV)	BRONZE (BZ) BLACK (BK) WHITE (WH) GREY (GR) OTHER (OT)	SLIP FITTER (SF) DIRECT ARM (DM) TRUNNION (TM) YOKE (YM) RDM-4 RDM-5

PRODUCT DIMENSIONS

75 | 110 | 150 WATT

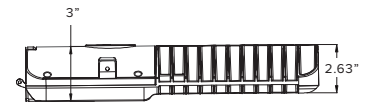
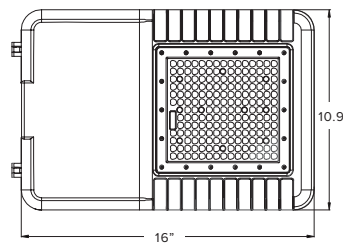

Weight: 22 Pounds

185 | 230 | 265 WATT

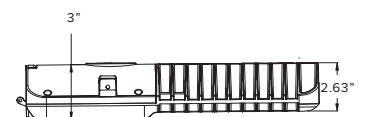
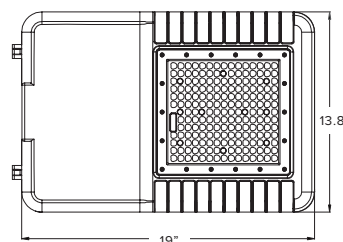

Weight: 25.4 Pounds



WWW.ESLVISION.COM
888.493.5559

Questions or Comments
www.eslvision.com
customerservice@eslvision.com
ESL Vision, LLC
1136 S 3600 W
Salt Lake City, UT, USA
Catalog# AL-2018-V2